

Talking Teaching 2018



29-30 November 2018
University of Canterbury
Christchurch
Aotearoa New Zealand

Table of contents

Welcome	2
Mihi Whakatau	3
Our Sponsors	4
Our Keynote Speakers	5
Programme pages	8
Maps	12
Key Information	14

Welcome

Tēnā koutou E te huinga tūtarakauika kua rukuruku mai nei ki tēnei puna kia kauria ai ngā ia wai o tēnā, o tēnā o tātou, nau mai, haere mai. Me he manga rau e rere ana koia nei te pūtahitanga. Ko tātou ēnei ngā roma wai, heke mai i tēnā kura o ngā whare huri noa. Anei mātou he au nō taua wai o whakaaro e mihi ana, e miha ana, tēnā rā tātou katoa.

Welcome teachers, educators, trainers, mentors, facilitators (and others), to the second Talking Teaching conference. Beneath the Talking Teaching disguise, you'll find the tenth annual Symposium organized by the Ako Aotearoa Academy of Tertiary Teaching Excellence, supported by Ako Aotearoa and the University of Canterbury.

We are thrilled to bring you all together from across the tertiary sector, for what we expect will be a vibrant exchange of ideas on teaching and learning, on the broad theme of inspiration and engagement. The conference has attracted an incredibly diverse programme of presentations, celebrating the range of teaching contexts within New Zealand's tertiary teaching landscape. We encourage you to enjoy your colleagues' insights, tips, and tricks, but also we challenge you to embody the theme of this conference – inspire and engage.

We are particularly excited to bring Talking Teaching to Canterbury, hosted by UC Professor Charles Fleischmann in the new Engineering complex, and supported with supreme efficiency by Amy Patté. As well as the conference programme of presentations, workshops, and other things that defy description, Charles has built in opportunities to get a sense of the 'new' UC, original home to the Student Volunteer Army.

On behalf of the organising committee, thanks for joining us and we hope you have an invigorating conference, enjoy campus life, and leave us having gained valuable insights to advance your teaching practice and research.

– **The Executive Committee of the Ako Aotearoa Academy of Tertiary Teaching Excellence**



Marc Wilson
(President)
Victoria University of Wellington



Marie McEntee
(Vice-President)
University of Auckland



Gail Harrison
Whanganui Learning Centre



Selene Mize
University of Otago



Adrian Woodhouse
Otago Polytechnic



Bradley Hurren
University of Otago



Charles Fleischmann
University of Canterbury



James Oldfield
Unitec Institute of Technology

Mihi Whakataau

Talking Teaching 2018 will open with a mihi whakataau (speeches of welcome in Māori) led by a representative of the Ngāi Tahu Research Centre (NTRC) at the University of Canterbury. Dr Joe Te Rito, Deputy Director Māori Ako Aotearoa, will lead the response on behalf of the visiting delegation.

Waiata (Song)

TE AROHA
(for mana whenua - local delegation)

Te aroha
Te whakapono
Me te rangimarie
Tatou tatou e

*Love
Hope
Peace
For us all*

EHARA I TE MEA
(for manuhiri - visitors)

Ehara i te mea
Nō nāiane te aroha
Nō ngā tupuna
Tuku iho, tuku iho.

*It cannot be said
That love is a new thing
As it is from our forbears
Who passed it down to us*

Our Sponsors

Ako Aotearoa

The organising committee and the Ako Aotearoa Academy of Tertiary Teaching Excellence would like to give thanks and acknowledge the support of key partner and sponsor Ako Aotearoa.



Australian Learning & Teaching Fellows

ALT is a silver sponsor of Talking Teaching 2018. Many of the fellows are in attendance at the conference and are delivering an array of exciting presentations and workshops. The Academy is delighted to partner with ALT this year.



The Australian Learning and Teaching Fellows support quality learning and teaching in Australian Higher Education. Our network consists of leading educators who undertake strategic, high-profile activities in areas of sectoral importance. The ALTF represents 108 scholars from multiple institutions and diverse discipline communities across Australia.

We are delighted to align with the Ako Aotearoa Academy for Talking Teaching 2018 and we look forward to listening, sharing and engaging with everyone in Christchurch. We are excited by the opportunity to discuss and build collaborative links between the ALTF network and the Ako Aotearoa Academy to further support quality learning and teaching across both Australia and New Zealand.

University of Canterbury

The committee extends sincere thanks to the University of Canterbury for their generous hosting of Talking Teaching 2018.



HealthCarePlus

HealthCarePlus is an exhibiting sponsor at Talking Teaching 2018. You will find their exhibition table near the registration desk in the foyer of the Engineering Core.



HealthCarePlus is a union-owned co-operative and not for profit incorporated society that provides everyday health cover for you and your family.

HealthCarePlus is excited to bring our products to you at the Ako Aotearoa Academy Talking Teaching 2018. The HealthCarePlus range of health insurance provides every day health cover exclusively to members of Education Sector Unions. HealthCarePlus representatives will be at the Symposium to provide you with more information and to show you how HealthCarePlus can provide you with access to competitive insurance products to support you and your family's health and provide financial protection for unforeseen events. Remember this cover is only available to financial members of participating Education Unions.

Our Keynote & Plenary Presenters

Professor Juliet Gerrard

Prime Minister's Chief Science Advisor



Professor Juliet Gerrard trained at Oxford University, where she completed a First Class Honours degree in Chemistry and a DPhil in Biological Chemistry. In 1993, she was appointed as a research scientist at Crop & Food Research, where her multidisciplinary research portfolio included a substantial element of applied research in the food science area. She was appointed as a Lecturer in Biochemistry at the University of Canterbury in 1998, where she became Professor and Co-Director of the Biomolecular Interaction Centre.

In 2014, she moved to the University of Auckland as a Professor in the School of Biological Sciences and the School of Chemical Sciences and is now the Associate Dean for Research in the Faculty of Science.

Juliet's research has a broad base and is interdisciplinary, cutting across biochemistry, chemistry, health, agricultural and food science and biomaterial design. It also incorporates a full spectrum of fundamental and applied research, ranging from Marsden projects to research for industry, and includes collaborations in the UK, USA and Australia.

From 2012-2016 she held a Callaghan Innovation Industry and Outreach Fellowship (at 50% FTE) focussed on creating an integrated research programme across Callaghan Innovation and the Universities of Canterbury and Auckland. During this time she also founded a start-up company, Hi-Aspect Ltd, which went on to receive seed funding from a private investor in 2017.

Juliet has over 150 publications, as well as three books. She won a National Teaching Award for Sustained Excellence in Tertiary Teaching in 2004 and has served on FRST panels and domain reviews. She enjoyed her role as Chair of the Cellular, Molecular and Physiological Biology Marsden Panel and Deputy Chair of the Marsden

Council prior to being appointed Chair in 2012. She stepped down from this role early in 2018, having overseen an increase in the fund from around \$54 million to over \$80 million and steered the Marsden Fund Council through the creation of the Fund's first investment plan.

Juliet has had an increasing interest in governance and served on the Board of Directors of Plant & Food Research Ltd from 2013-2018. Juliet has resigned her roles on Boards to take up this position and won't apply for research funds in New Zealand while she holds the role.

PRESENTATION

Beyond the tyranny of content – reframing our teaching using inclusive practices and critical thinking as essential foundations for learners in the 21st Century

Thursday 29 November, 10.15am

In this talk I will reflect on my own teaching practice and how it has influenced my approach to my new role. I will also highlight two themes which I hope might provoke discussion amongst the audience. Firstly, how to make the learning environments and the curriculum more inclusive for all New Zealanders, and secondly how teaching and learning need to be reframed in the age of ready access to information and mis-information.

Dr Te Taka Keegan

Senior Lecturer, The University of Waikato, Te Whare Wānanga o Waikato
2017 Prime Minister's Supreme Award Winner in Tertiary Teaching Excellence



Te Taka Keegan is a Lecturer in the Computer Sciences Department at the University of Waikato. His tertiary teaching career began in the early 2000s with the Māori department, where he learnt a number of kaupapa Māori

principles that he was able to later transfer to Computer Science. Te Taka has also been involved in a number of projects involving te reo Māori and technology including the Māori Niupepa Collection,

Te Kete Ipurangi, the Microsoft keyboard, Microsoft Windows and Microsoft Office in Māori, Moodle in Māori, Google Web Search in Māori, SwiftKey in Māori and the Māori macroniser. At the centre of all of Te Taka's research and work is a passion for the Māori language.

PRESENTATION

Using Humour in Teaching

Friday 30 November, 9am

I believe an important part of teaching is being able to connect with your students. One way to make that connection is through humour. I use humour frequently in the teaching of computer science, a field that may seem to many to not be humorous at all. This is certainly the case amongst many of my colleagues! In this talk I will discuss the avenues in which humour can be used in teaching, some of the many pitfalls and the many rewards. I will share some of the efforts my colleagues had in using humour, and some of my go to jokes. At the very least it should put a smile on your face.

Emeritus Professor Russell Bishop

Emeritus Professor of Māori Education,
The University of Waikato



Russell Bishop is Emeritus Professor of Māori Education in the Faculty of Education at the University of Waikato, Hamilton, New Zealand. He is well known for developing and directing Te Kotahitanga, a large New

Zealand Ministry of Education funded research and professional development project from 2001 to 2012. This project demonstrated how teachers and other school leaders could improve the educational achievement of Māori students in mainstream classrooms by implementing a culturally responsive pedagogy of relations. Since his retirement from Waikato University, he has developed the notion of relational pedagogy and leadership further with Cognition Education in New Zealand, Australia and Canada. He is the author of 7 books and approximately 80 other quality assured publications. He has delivered over 100 keynote addresses, nationally and internationally, has attracted approximately \$32.5 million in research and development contract funding in recent

years, and has won numerous awards for his work including a recent ONZM.

PRESENTATION

Teaching to the North-East

Friday 30 November, 11.50am

In our attempts to improve Māori and other Indigenous and Marginalised students' educational outcomes, there are a number of problems that we need to address if we are to make progress that is sustainable. These problems include;

- There are no theories of practice that resonate with marginalised peoples,
- There are no common code of practice or scaling,
- There is a plague of 'good ideas' that masquerade as evidence-based practice,
- Most PLD is ineffective, open to political positioning and focuses on peripheral rather than central concerns,
- Teachers' voice and understandings are heard more often than students,
- Culture is most often seen as customs and objects, rather than as a medium or sense-making processes,
- Leadership is often spoken about in terms of transforming practices rather than in relation to student outcomes.

My plan for the presentation is to illustrate each point with evidence from my own research and from an effective, large-scale, evidence-based education reform project I originated and directed in New Zealand; Te Kotahitanga. I will be demonstrating: how the theory of relationship-based pedagogy, that resonates with Māori as an Indigenous people and promotes student 'voice,' was developed out of my own doctoral research; how the Te Kotahitanga Effective Teaching Profile (ETP) was developed as culturally responsive pedagogy where culture is seen as sense and meaning-making that promotes a common code of practice; how the GPILSEO model that aimed to support pedagogic/instructional leaders to create the context within which the ETP can be implemented effectively.

I will identify the main features of the profile and illustrate how the three main parts interact. I will conclude with evidence that illustrates how when ALL educators implement ALL parts of the profile, no matter their level within education, we see

relationship-based learning become integral to the ongoing business of schooling with consequent implications for student achievement and the sustainability of achievement gains.

Professor Catherine Moran

Assistant Vice-Chancellor
University of Canterbury



Professor Catherine Moran is the Assistant Vice-Chancellor at the University of Canterbury. She coordinates the Graduate Profile programme and other key projects such as enhancing the student experience.

RESEARCH INTERESTS

Active research interests include language development, adolescent language disorders and traumatic brain injury.

- Adolescent language disorders
- Head injury
- Language development

PRESENTATION

Talking Teaching 2018 - Opening Address
Thursday 29 November, 9.30am

Professor Catherine Moran will offer her opening remarks to welcome the delegation to the University of Canterbury.

Professor Angus Macfarlane

Professor of Māori Research
University of Canterbury

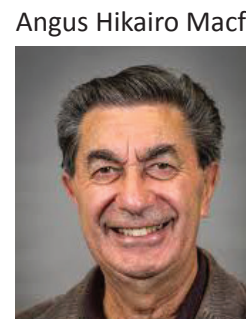

Angus Hikairo Macfarlane is Professor of Māori Research at the University of Canterbury (UC), and Director of Te Rū Rangahau, the Māori Research Laboratory. His research focuses on exploring Indigenous and sociocultural imperatives that influence education and psychology. Avid about Indigenous advancement, he has pioneered several theoretical frameworks associated with culturally-responsive approaches for professionals working across these disciplines. Professor Macfarlane's prolific publication portfolio and exemplary teaching abilities have earned him national and international standing in his field of

scholarship. In 2010, he received the Tohu Pae Tawhiti Award from the New Zealand Council for Educational Research for outstanding contributions to Māori research over an extended period of time. In 2013, he was the first Māori recipient of the University of Canterbury Research Medal – the highest honour that the UC Council can extend to its academic staff. In 2015, he received the national Ako Aotearoa Tertiary Teaching Excellence Award for specialist services in the field of kaupapa Māori. Last year, 2017, the University of Canterbury Students Association awarded him the Supervisor of the Year title for his exceptional mentoring of postgraduate scholars whose interests include exploring cultural diversity and its dynamic features from the past, the present, and into the future. His most recent distinctive acknowledgement was being elected to the Fellowship of the Royal Society of New Zealand Te Apārangi. Professor Macfarlane is the Senior Māori Advisor (Kaihautū) for the New Zealand Psychological Society, a national body of over 1700 professionals and scholars, and a research leader and advisor on several ministerial-funded projects.

PRESENTATION

Talking Teaching 2018 - Closing Remarks

Friday 30 November, 12.30pm

Dr Angus Macfarlane will offer his insights and closing remarks to wrap-up Talking Teaching 2018.

TIME	SESSION	VENUE
8.00	Registration Registration, tea & coffee	Engineering Core, Foyer
9.00	Move to Lecture Theatre	Lecture Theatre E8
9.10	Welcome Mihi Whakatau with opening address - representative of Ngāi Tahu Research Centre, University of Canterbury (UC), Prof Catherine Moran, Assistant Vice-Chancellor, UC, and Marc Wilson, President, Ako Aotearoa Academy of Tertiary Teaching Excellence	Lecture Theatre E8
9.45-10.10	Morning Tea	Recharge Lounge
10.15-10.45	Keynote Address – Professor Juliet Gerrard, Prime Minister’s Chief Science Advisor: ‘Beyond the tyranny of content – reframing our teaching using inclusive practices and critical thinking as essential foundations for learners in the 21st Century’	Lecture Theatre E8

Parallel Presentations - are 25, 40 or 55 minutes. After each presentation there is a five minute turnaround for the next presenter to come in and get set-up. We ask that you please respect this turnaround time

TIME	ROOM E5: DIVERSITY	ROOM E6: FEEDBACK FOR BETTER TEACHING	ROOM E7: PERSPECTIVES ON EMPLOYABILITY
11.00-11.25	Juliet Gerard, University of Auckland: Diversity and STE(A)M – a conversation	NON-THEMATIC PRESENTATION: Christine Rubie-Davies, University of Auckland: Can the implicit bias of pre-service teachers be changed?	Cheryl Brown, Niki Davis et al, University of Canterbury: Engaging students in blended learning - UC students' perspectives
11.30-11.55	Pam McCrorie, Curtin University: Experiences of health professional students of educational yarning as a teaching and learning pedagogy in Indigenous studies.	Lynne Roberts et al, Curtin University: Learning Analytics: Students’ Attitudes, Understanding and Action	Selene Mize, University of Otago: Computer-based examining
12.00-12.25	Anne-Maree Ward, UC international College: Ensuring International Student Learning Success; Navigating the New Zealand Tertiary Context	Christa Jacenyik-Trawöger, University of NSW: Summative Peer Review of Teaching – reflections on a university-wide initiative	Jo Coldwell-Neilson, Deakin University: Revisiting digital literacy to improve assessment
12.30-12.55	Kelly Pender, Toi Ohomai Institute of Technology: Effective teaching for Māori students on the Certificate in Fitness programme at Toi Ohomai Institute of Technology	Keith Dixon, Te Whare Wānanga o Waitaha: A retrospective analysis of curricular accounting	Renee Stringer, Otago Polytechnic: Assessing Assessment - challenging the system by giving students agency to assess themselves

1.00-1.50 **LUNCH** – Recharge Lounge

TIME	ROOM E5: DIVERSITY	ROOM E6: NON-THEMATIC	TIME	ROOM E7: PERSPECTIVES ON EMPLOYABILITY
2.00-2.25	Sara Kindon, Victoria University of Wellington: What helps refugee background students succeed in tertiary education?	Marina Harvey, University of New South Wales: Reflection for engaging teaching and inspiring learning	2.00-2.40	Richard Nyhof, Otago Polytechnic, and James McKay, Weltec: Engaging with work - a degree apprenticeship
2.30-2.55	Wendy Green, University of Tasmania: Engaging ‘students as partners’ in global learning: Some guiding principles for learning in partnership across cultures	Kym Fraser, Swinburne University of Technology: Inducting new teachers to engage and inspire learners	2.45-3.25	Geoff Scott, Western Sydney University: Preparing work ready plus graduates for an uncertain future
3.00-3.25	NON-THEMATIC PRESENTATION Jacquelyn Cranney and Sue Morris, University of New South Wales: Why should student self-management, success and wellbeing be a curricular concern?	Mohamed Alansari, University of Auckland: From formative to summative: Can positive ratings of tertiary classroom environments predict ratings of course quality?		

3.30-3.45 **Afternoon Tea** – Recharge Lounge

TIME	DRAWING ROOM 1: DIVERSITY SCHOWCASE	DRAWING ROOM 2: PERSPECTIVES ON EMPLOYABILITY SHOWCASE	CONFERENCE FOYER, JOHN BRITTEN BUILDING (1 minute walk to building adjacent to Engineering Core): ENHANCING TEACHING SHOWCASE
4.00-4.55	Ksenija Napan, Massey University, and Helene Connor, University of Auckland: Campfire session: Walking the bi-cultural talk in Aotearoa	Dawn Bennett, Curtin University: Workshop: Making employability development attractive for staff and students	Marie McEntee and Melanie Wall, University of Auckland: Workshop: Doing is Being - Experiential learning inside and outside the classroom for teaching complex ‘human’ concepts
5.00-6.00	College of Engineering Lab Excursions (optional) – please sign up at the registration desk		
5.00-7.00	Pre-dinner drinks at The Shilling Club (cash bar)		
7.00-10.00	Conference Dinner at The Foundry with presentation by Phil Bishop, University of Otago: <i>How to survive in the jungles of Borneo with a bunch of undergraduate students!</i> , Kapahaka performance by local school group and song by Jane Venis, Otago Polytechnic		

POSTER PRESENTATIONS
(poster presentations available to view in the foyer of Engineering Core for the duration of the conference)
Gerard Duignan, Scott Casley & Deb Stewart, WelTec & Whitireia: Real Good Teacher guides
Kieran Gulvin, Lynne Roberts and Joel Howell, Curtin University: Can the Technology Acceptance Model predict student intention to use Learning Analytics and Gamification?
Jaci Mason, Lynne Roberts, Helen Flavell, Curtin University: A Scoping review of the literature on consensus moderation

Parallel Presentations - are 25, 40 or 55 minutes. After each presentation there is a five minute turnaround for the next presenter to come in and get set-up. We ask that you please respect this turnaround time

DRAWING ROOM 1: TECHNOLOGY	DRAWING ROOM 2: CAMPFIRE SESSIONS	ROOM E8: ENHANCING TEACHING
NON-THEMATIC PRESENTATION: Elizabeth Beckmann, Beth Beckmann & Associates: Professional recognition in teaching: Is there a gendered perspective?	Deb Stewart, Eastern Institute of Technology: Campfire session: Beyond Pākehā paralysis	Keith Willey et al, University of Sydney: I feel incompetent and it’s your fault!
Trudi Cooper, Edith Cowan University: Some unintended effects of demand-driven funding on student choice and graduate employment	Colin McGregor, Adult & Community Education (ACE) Aotearoa: Campfire session: From pretty dodgy to better-gogy, setting standards to be better educators	Jane Terrell, Massey University: Koru Mindfulness: a NZ debut
Gerard Duignan, Deb Stewart and Agustilia Rodrigues, Weltec & Whitireia Institute of Technology: Teaching strategies for enhancing employability skills	Tatiana Daysh, Massey University: Campfire session: Calculating calmly	Daphne Robson, Ara Institute of Canterbury: Engaging students in non-routine thinking
Rachel Spronken-Smith et al, University of Otago: How are we preparing our PhD graduates for careers? A comparative case study between US and NZ universities	Emily Bennett, University of Western Australia: Campfire session: Student Voice on the Student Experience: Busting the Dominant Myth	Mauro Mocerino, Curtin University: Enhancing learning in the laboratory - Identifying and promoting best practice in university science laboratory classes

DRAWING ROOM 1: TECHNOLOGY	DRAWING ROOM 2: CAMPFIRE SESSIONS	ROOM E8: ENHANCING TEACHING
James Oldfield, Unitec Institute of Technology: Workshop: Empowering collaborative learning through technology (NB: <i>participants should bring their own digital device</i>)	Jacquelin McDonald, University of Southern Queensland: Campfire session: Communities of Practice - Sharing our dreams and schemes	Rena Heap, University of Auckland: Addressing a perennial problem: Increasing student engagement with course readings
David Sjoberg and Allan Sumner, Flinders University: Workshop: Peranbun Kungun Yunnan (Sharing listening talking)	Lyn Williams, Ara Institute of Canterbury: Campfire session: Teachers observing teachers	Iouri Belski, Royal Melbourne Institute of Technology: Educating the Edisons of the 21st Century: How to succeed in developing creativity skills?

ROOM E5: TECHNOLOGY SHOWCASE	ROOM E6: ENHANCING LEARNING SHOWCASE	CNRE COMP SUITE (LEVEL 2): ENHANCING LEARNING SHOWCASE
Selena Chan, Ara Institute of Canterbury: Workshop: e-assessments for learning: Matching digital tools to enhance e-feedback (NB: <i>participants should bring their own digital device</i>)	Ben Kennedy et al, University of Canterbury: Disastrous Virtual Fieldtrips and Drilling into Magma	Jane Venis, Otago Polytechnic: Workshop: Drawing to Connect

Friday 30 November

TIME	SESSION	VENUE
8.30	Registration Registration, tea & coffee	Engineering Core, Foyer
9:00	Plenary Address Dr Te Taka Keegan, University of Waikato: Using humour in teaching	Lecture Theatre E8
9.45-10.10	Morning Tea	Recharge Lounge

Parallel Presentations - are 25, 40 or 55 minutes. After each presentation there is a five minute turnaround for the next presenter to come in and get set-up. We ask that you please respect this turnaround time

TIME	ROOM E5: LUCKY DIP	DRAWING ROOM 1: LUCKY DIP	ROOM E6: LUCKY DIP
10.15-10.55	Les Kirkup, University of Technology Sydney: Workshop: Inquiry-oriented learning through authentic, practical experiences	Nicolette Lee, La Trobe University: Workshop: Capstones across disciplines - learning to fly	Phil Osborne, Samuel Mann and Richard Mitchell, Otago Polytechnic: Panel: The challenge of assessment - Utilising Interpretive Dance in a Business degree
11.00-11.40	Angela Brew, Macquarie University: Workshop: Engaging and inpiring students through research-based learning	Elizabeth Beckmann, Beckmann & Associates: Workshop: Professional recognition in teaching and leadership networks	MEETING ROOM 1 Adrian Woodhouse and Richard Mitchell, Otago Polytechnic: Fish bowl: I make; therefore, I know - Assessing cognitive and creative problem-solving using embodied performances of practice

--	--	--	--

Closing Presentations (Plenary)		
11.50	Keynote Address Emeritus Professor Russell Bishop, University of Waikato: Teaching to the North-East	Lecture Theatre E8
12.30	Wrap-up & Close Dr Angus Hikairo Macfarlane, University of Canterbury	Lecture Theatre E8
1.00-1.30	Farewell lunch – Recharge Lounge	Recharge Lounge

Parallel Presentations - are 25, 40 or 55 minutes. After each presentation there is a five minute turnaround for the next presenter to come in and get set-up. We ask that you please respect this turnaround time

DRAWING ROOM 2: LUCKY DIP	TIME	ROOM E7: LUCKY DIP
Deb Hill, Whanganui Learning Centre: Workshop: How do we deepen thinking with a capital ‘D’?	10.15-10.40	Steve Cutler, University of Otago: Putting agenic student feedback and criteria setting into practice: steps and tools
Marina Harvey, University of New South Wales: Workshop: Engaging sessional teaching	10.45-11.10	Trudi Cooper, Edith Cowan University: Engaging teaching, inspiring learning - Universities after Industry 4.0
	11.15-11.40	PECHA KUCHA SESSION Joy Higgs, University of New South Wales: Education for employability Cheryl Brown, University of Canterbury: The future of education is Open - Open Education Resources (OERs) in Teaching and Learning Kristin Turnbull and Sonal Bhalla, University of New South Wales: Transforming teacher development at UNSW Marc Wilson, Victoria University of Wellington: Student demonstrations (of the good kind)

Maps

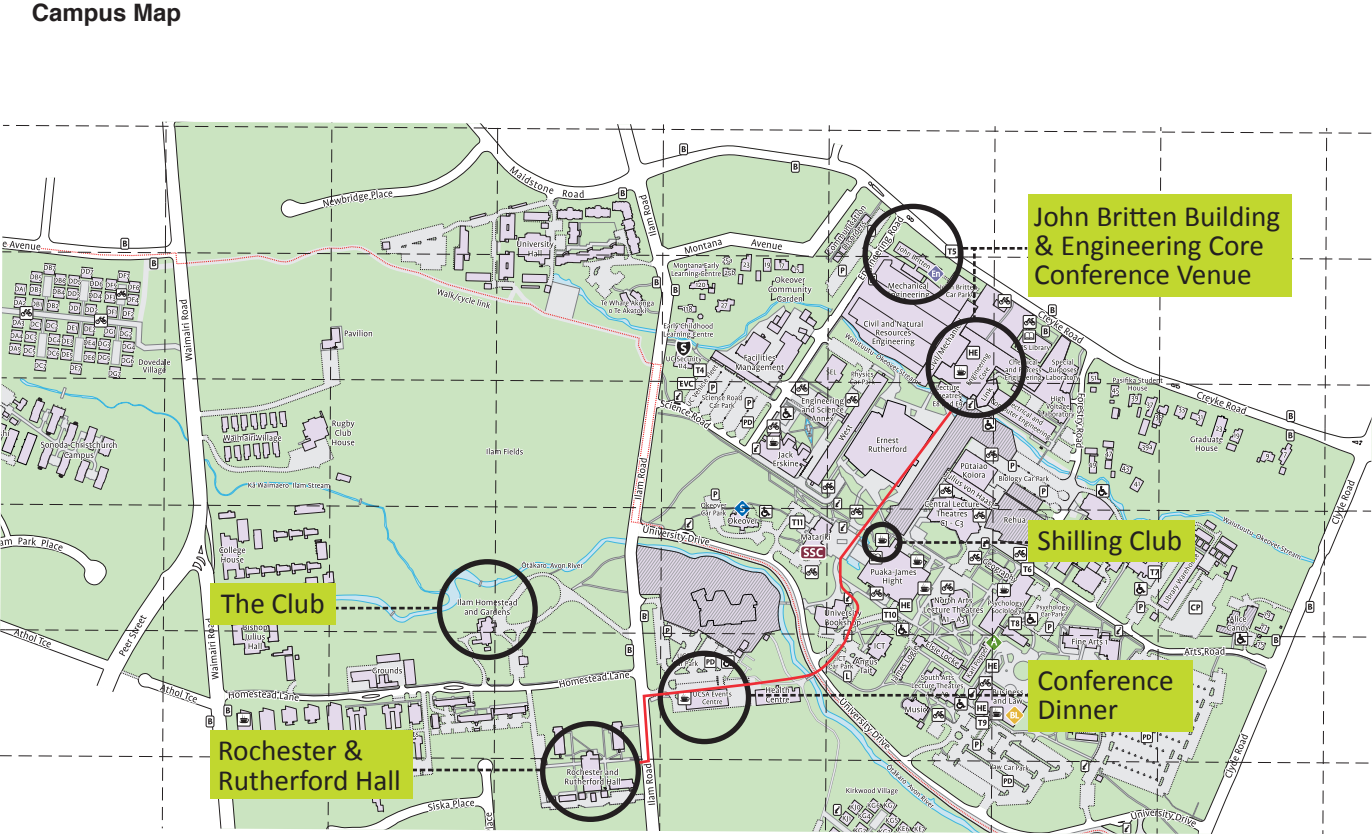
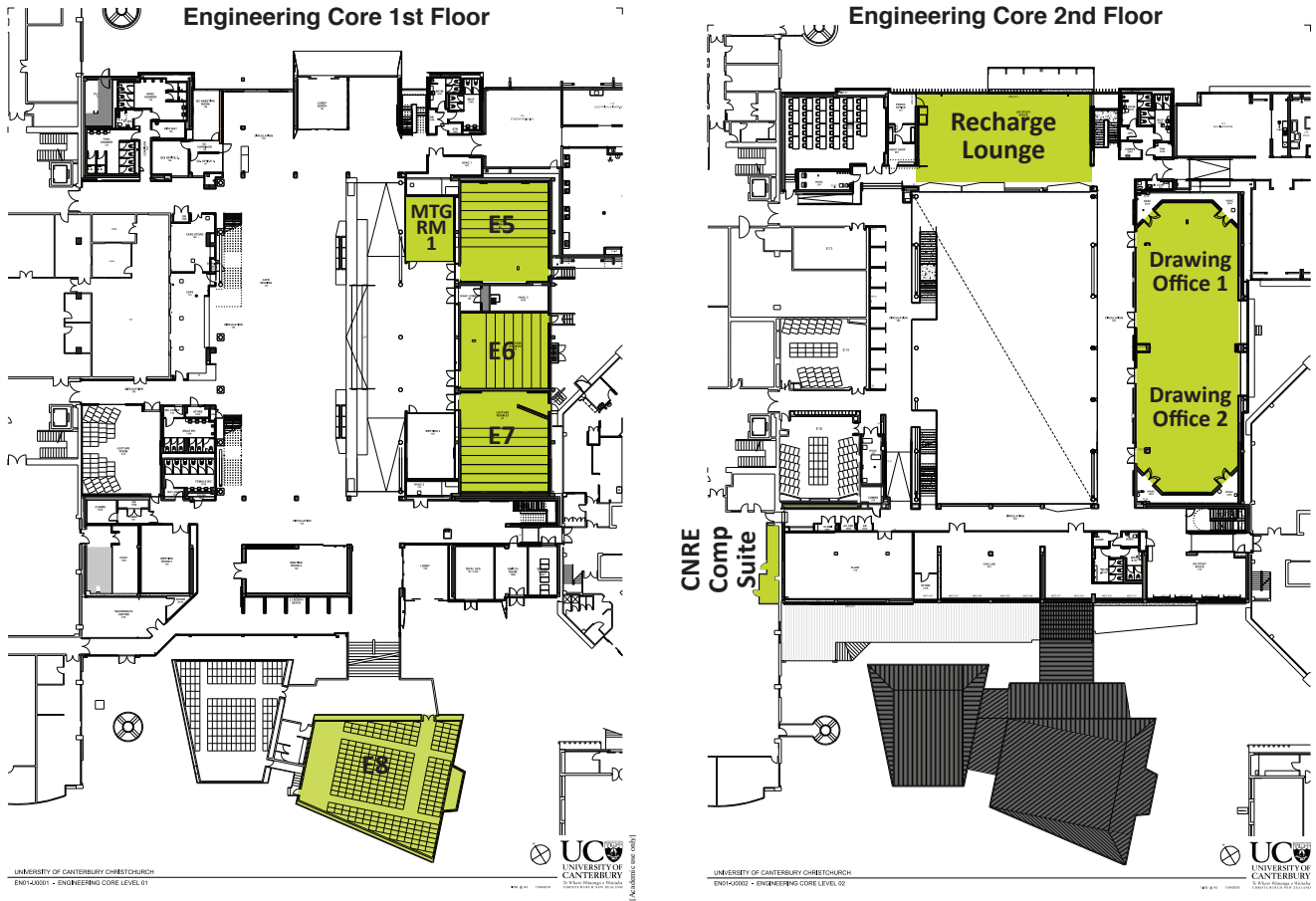

Photograph of the entrance into the Engineering Core

Key Information

The following information is designed to make your attendance at Talking Teaching 2018 as pleasant as possible. If you require assistance at any time, please come to the registration desk and our organisers will do what they can to help.

Venue

Talking Teaching 2018: Engaging Teaching, Inspiring Learning will be held at the College of Engineering, University of Canterbury. Sessions will take place in various rooms and lecture theatres in the state of the art facility called the **Engineering Core**.

Address: 69 Creyke Rd, Ilam, Christchurch 8041

Entrance: Please access the Engineering Core via the entrance pictured on page 12.

NB: #69 Creyke Rd is the official address for the College of Engineering - on google maps this will take you to the John Britten building next door to the Engineering Core.

Registration Desk

On arrival please collect your conference bag and nametag from the registration desk. The registration desk will be open from 8am on Thursday 29 November and 8.30am on Friday 30 November. The desk will be located in the foyer of the Engineering Core (College of Engineering, UC). The registration desk will close at the end of the formal session each day.

Full Schedule of Abstracts

Hard copies of the full schedule of abstracts will be available to read from the conference registration desk. Environmental sustainability is important to us so we are providing hard copies for sharing rather than a copy for each delegate. Please note that the full schedule of abstracts is also available on the conference website: <https://akoacademy.ac.nz/ako-academy/talking-teaching-2018>

Social Media

Please use **#talkingteaching18** if posting or tweeting about the conference on social media.

Social Programme

Daytime

Please review the programme for confirmation of break times. All-day tea and coffee, daily morning tea, lunch and afternoon tea are included in your registration fee and served in the Recharge Lounge located on the mezzanine floor of the Engineering Core. Some seating is provided in this space but delegates are welcome to take their lunch to any available hub or communal space on either floor of the Engineering Core.

Evening

Thursday 29 November
Conference Dinner at The Foundry, 7pm-10pm (cash bar) Pre-dinner drinks at The Shilling Club, 5pm- 7pm (cash bar)

The conference dinner will be held at the fantastic venue **‘The Foundry’**. The Foundry is the main bar and events centre for the University of Canterbury Students’ Association. It is located about a five minute walk from the College of Engineering. Dinner is a three course Christmas buffet. Some non-alcoholic drinks are provided. A cash bar is operating for all other drinks. Dinner will include a presentation by **Phil Bishop, University of Otago** entitled *How to survive in the jungles of Borneo with a bunch of undergraduate students!* Delegates can also expect some fun in the form of an after-dinner table quiz and a kapa haka performance by a student group from a local school in Christchurch.

NB: a red dot will be visible on your name tag if you indicated you would attend the dinner at the time of registering for Talking Teaching. Your name tag is required for access to The Foundry.

The **ground floor** of **The Shilling Club** is available for delegates to gather for pre-dinner drinks from 5pm-7pm. The Shilling Club is a beautiful cafe and bar with indoor and outdoor seating available. A cash bar is available to delegates during this time.

College of Engineering Lab Excursions

Otago University may expel students for burning sofas but when our students burn sofa here at Canterbury, we give them graduate degrees. Come along on the CNRE laboratory excursion and see our new 5 MW furniture calorimeter, biggest in Australasia. We will tour our brand-new fire engineering laboratory and structural engineering lab. This is your chance to see some of the most impressive engineering research facilities in the world. The excursion will start promptly at 5:00PM on Thursday and take approximately 1 hour.

Please register to attend by leaving your name at the registration desk. Registration must be in by 2pm on Thursday.

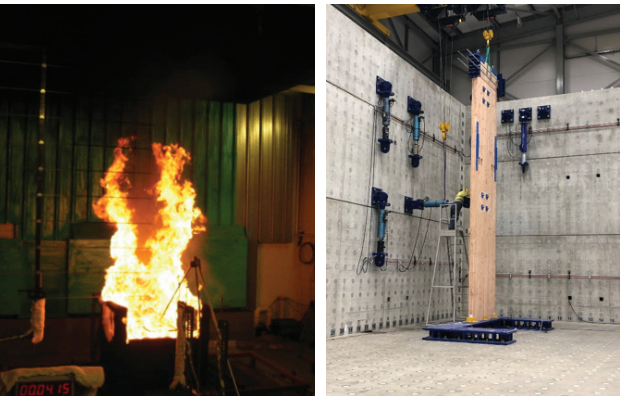

Conference ID

Delegates are asked to wear their conference name tag for the duration of the conference. Your name tag gives you access to the catering buffet and all conference sessions.

Internet Access

A guest wireless account has been created especially for Talking Teaching 2018. All users need to select UCvisitor wireless and enter below username and password.

Account Details		
	Network Name	UCvisitor
	Username	uc3300
	Password	000901
	Account Activation	Tuesday, 27 November 2018, 3:46 PM
	Account Expiration	Friday, 30 November 2018, 8:46 PM

Visitor parking

Pay and Display

Visitors to campus are able to park in designated visitor parking areas. To park in these areas visitors will need to display an \$8 all-day parking coupon obtained from a pay-and-display unit.

Parking coupons can also be pre-purchased from the following designated outlets on campus:

- Cafe 101
- University Bookshop
- The Collective at College of Education
- ReBoot Cafe
- Recreation Centre
- 114 Ilam Road - Security

Please refer to the map of designated car parking areas. <https://www.canterbury.ac.nz/life/parking/parking-maps/>

Park at your own risk

The planning committee and hosts and University of Canterbury take no responsibility for any vehicles, bikes, scooters or motorcycles parked on university-controlled property, whether or not vehicles are parked in designated parking areas. Staff, visitors and contractors park at their own risk and the University does not accept any responsibility for damage to or theft of vehicles while parked on university grounds.

Getting to Campus

We recommend using Super Shuttle for transfers to and from Christchurch Airport to campus. A promo code “Aotearoa” has been set up for Talking Teaching delegates and can be booked though the website www.supershuttle.co.nz. The promo code will give delegates a 10% discount on transfer costs. Delegates can also utilise this promotion in any city that Super Shuttle services should they wish to book a shuttle to or from their home airport. See screenshot where promo code is entered.

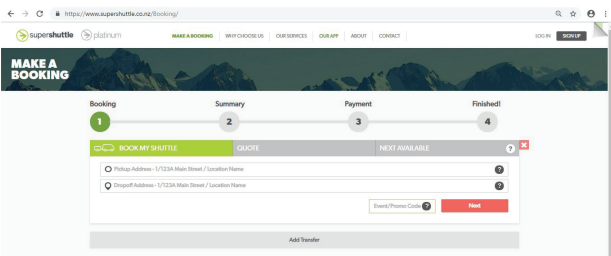

Useful Numbers

Amy Patté - Conference Manager -
+64 (0)27 490 4624

Super Shuttle - 0800 748 885 or +64 (0)9 522 5100

Gold Band Taxis - +64 (0)3 379 5795

Green Cabs Christchurch - 0800 464 7336

Useful Websites

Ako Aotearoa Academy of Tertiary Teaching
Excellence - www.akoacademy.ac.nz

Ako Aotearoa - www.ako.ac.nz

The University of Canterbury -
<https://www.canterbury.ac.nz/life/Australian>

Learning and Teaching Fellows - <https://altf.org/>
Health Care Plus - <https://healthcareplus.org.nz/>

Notes

[illegible]



**Australian
Learning &
Teaching
Fellows**

